

TRADEWEIGH®

Legal-for-Trade Onboard Weighing



the weighing experts

Approved legal-for-trade

Where operators charge-by-weight at the point of collection or delivery from the cab or require greater accuracy. TRADEWEIGH® is an approved to class III & IIII chassis weighing system & installs to any type of rigid truck, perfect for waste & recycling trucks.

- All types of rigids 7.5 to 32 tonne GVW
- OIML R76 approved to Class III and IIII
- Works on inclines up to 10% (1 in 20)
- Accurate to 20 kg in 15,000 kg
- Net & gross display
- 4, 6 or 8 loadcells

High accuracy with lasting reliability

Engineered for heavy vehicles, the approved TRADEWEIGH® onboard weigher is designed for high accuracy in rugged conditions helping operators to increase profits and protect investments. TRADEWEIGH® comprises of four, six or eight approved loadcells which are mounted between the chassis and body. The 920i in-cab indicator is accurate to 1 part in 2,000; 20kg in 20,000kg and can be coupled to a printer or tracker.



920i Onboard weight indicator

- Selectable character sizes 6-30 mm high characters
- Large 114 x 86 mm back-lit LCD graphical display
- Five soft keys with 10 user-defined functions per screen
- Ten programmable display screens
- IP66 stainless steel enclosure
- Two slots for option cards
- Local-remote indicators
- Multi range/interval
- Alibi data storage
- Audit trail tracking



Certified loadcell

Approved loadcells

The VWS double ended centre loaded shear beam type loadcell is nickel plated alloy steel. A reliable sealing is ensured by the proprietary TRANSEAL compound and additional mechanical protection of the strain gauge area. A specially designed mounting arrangement ensures continuous robust service.

- Sealing: IP67
- Low profile construction
- Optional mounting hardware
- Loadcell capacity 22 tonne

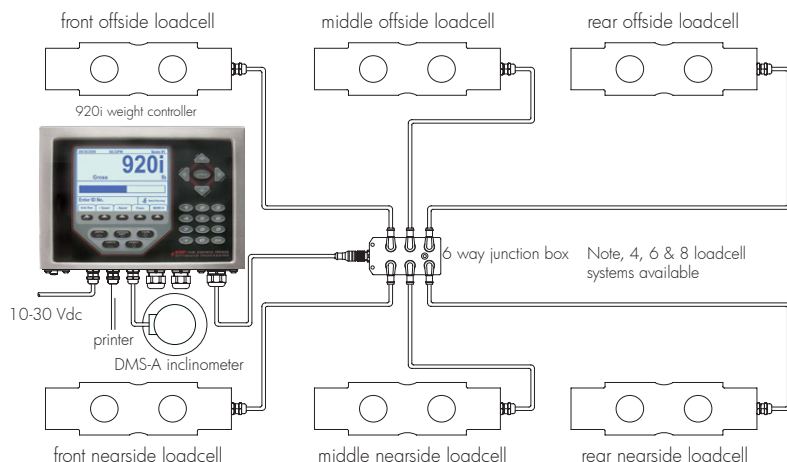

Loadcell installation

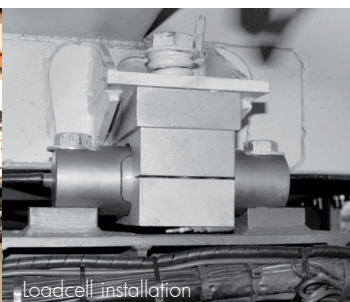

Loadcell installation



SALES

Vehicle Weighing Solutions Ltd.
Unit 5, Southview Park, Marsack Street
Caversham, READING RG4 5AF
T: 0118 946 1900
F: 0118 946 1862

INSTALLATIONS

Vehicle Weighing Solutions Ltd.
Ireland Industrial Estate, Adelphi Way
Staveley, Chesterfield S43 3LS
T: 01246 472028
F: 01246 913478

need help? call service

08458 625 526

info@vwsLtd.co.uk
www.vwsLtd.co.uk

TRADEWEIGH®

The VWS Legal-for-trade chassis weighing system can be fitted to all types of rigid vehicles as an original equipment or retrofit through an approved body builder or in our own workshops. Our engineers calibrate and commission TRADEWEIGH® witnessed by a weights and measures officer - a legal requirement for a full certification.

- REL's & FEL's
- Hookloaders
- Recycling trucks
- Tipping trucks
- Demountables
- Tankers
- Mixers

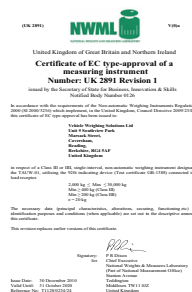

SPECIFICATIONS				
PARAMETERS	MINIMUM	TYPICAL	MAXIMUM	UNIT
SYSTEM				
Class III				
Capacity	20e	15000	30000	kg
Scale interval (e)	10			e
Number of divisions (n)	500		1500	
Class IIII				
Capacity	10e	15000	30000	kg
Scale interval (e)	10			e
Number of divisions (n)	100		1000	
Tilt compensation	-10		+10	°
POWER INPUT				
Power consumption			15	VA
Operating voltage		10 - 30		Vdc
INDICATOR				
Linearity correction (optional)	5 points			
Indicator	Indicator LCD with 4 alpha-numeric lines and LED backlighting			
Setup and calibration	Full digital with visual prompting in plain messages			
Digital filter	Sliding window average from 0.1 to 30.0 seconds			
Zero range	-20		+20	% of full capacity
Operating temperature	-10		+50	°C ambient
Storage temperature	-10		+50	°C ambient
Humidity (non-condensing)			90	%
Protection level	IP66 when panel mounted or with rear boot			
LOADCELLS				
Capacity (per load cell) (Emax)			22,000	kg
Accuracy class	OIML R60 C3			
Output sensitivity	3.0 ± 0.008			mV/V
Safe overload			150	% of Emax
Temperature range, compensated	-10		+40	°C
Material	Alloy steel			
Protection class	IP67			
ACCESSORIES AND OPTIONS				
Data interface	4/6-wire loadcell connection. RS232. RS485. Analogue output. 24 Channel I/O Pulse input interface. Bus interface			
Serial outputs	RS-232 serial port for remote indicator, network or printer supports RS-485 transmit for remote indicator Transmission rate: 2400, 4800, 9600 or 19200 baud			
2 assignable function keys	Printing, unit switching, counting, manual hold, peak hold and totalising			
Battery backed-up real-time clock	Battery life: 10 years minimum			